

SHIPLAKE MEMORIAL HALL
AND INSTITUTE.

To the immortal memory of those
who fell in the Great War 1914—1918.

Order of Masonic Ceremony

in connection with the laying of the

FOUNDATION STONE,

AND OF

The Unveiling of the Memorial Tablet

AND

DEDICATION

BY THE

Right Rev. BISHOP SHAW, D.D.,

Assisted by the Rev. C. A. W. AYLEN,

AT 4 P.M. ON

SATURDAY, JULY 18TH, 1925.

COMMITTEE :

Sir Frederick Eley, Bart. (*Chairman*); Mr. H. J. Young (*Vice
Chairman*); Mr. W. Cooling Lawrence (*Treasurer*); Mr. C. F. Harding
(*Chairman of Parish Council*); Messrs. P. Beresford, O. M. Burge,
C. Day, H. Farmiloe, A. Hinstead, F. Jones, W. Morley-Wood, T.
Newberry, F. W. Nicholson, H. Sanger, W. J. Styles, Hartley Sharpe.
F. Simpson (*Hon. Sec.*), The Gables, Shiplake.

SHIPLAKE MEMORIAL HALL

— AND —

VILLAGE INSTITUTE.



Introductory.



Last September a circular was sent out to residents in Shiplake with an illustration of the proposal hall, and the following wording appeared on it :—

“The Architect’s estimate of the cost of the Hall, based on the present cost of materials and rates of labour, is £3,300, and it is confidently hoped that estimates will be obtained not exceeding that sum.

“For many years past there has been an increasing need for a suitable Hall in Shiplake, which would be available for public meetings, and fill the position in the parish that a town hall does in larger places for the community.

“A site, which the Architect thinks to be very suitable and central, an important point in so scattered a parish, has been offered by Mr. Mardon in the school field adjoining the land owned by Mr. Harrison.

“There have been already two War Memorials erected to commemorate the gallant sacrifice of those connected with Shiplake who have gone forth never to return, but it is felt by many, if the necessary funds can be raised, that a Memorial Hall, as designed by Mr. Sainsbury, would be appreciated by the men who have been permitted to come back to their homes, and serve also to remind us all of those whose names ‘liveth for evermore.’ Ten years have just gone by since the call went forth ‘Your King and Country need you,’ and it is hoped that by next August sufficient support may have been received to justify proceeding with the building the proposed Hall.”

A public meeting, presided over by Lord Phillimore, was held in October, at which the offer was made that Mr. and Mrs. Mardon would defray the expenses of building the Hall in accordance with the Architect’s planned estimate, condition-

ally on the sum of £1200 being raised to provide a fund for its future upkeep, and for the furnishing and electric light fittings. A committee was subsequently formed, with Sir Frederick Eley as chairman, Mr. Lawrence, treasurer, and Mr. Simpson, hon. sec., and they after careful deliberation felt that the plans were not adequate for the increasing growth of Shiplake and that it would be most desirable, if the money could be raised, that a Village Institute also might be built adjoining the Hall, but distinct from it.

That meant the preparation by Mr. Sainsbury of entirely new plans, tenders were obtained and the contract placed in March with local builders, Messrs. Walden & Son, for £8,384. Mr. and Mrs. Mardon are paying for the entire cost of erection and giving, in addition, the site on condition that the sum of £2000 is raised locally before June next to provide towards a Maintenance Fund, and for the furnishing of the Hall and Institute.

This offer has been gladly accepted by the Committee, promises and cash so far received amount to over £500, leaving £1500 still to be raised.

The following descriptive account by Mr. Sainsbury of the buildings now in course of erection thoroughly explain the plans which are illustrated on another page, and will be of interest :—

The Hall and Institute Buildings, Shiplake-on-Thames, are being built chiefly of a local dark hand-made brick, and roofed with dark hand-made tiles the windows being glazed with lead glazing throughout, and with massive oak doors to all external doorways.

Externally an endeavour has been made to design a building in keeping with the purpose for which it is to be erected, and by a grouping of features and general balance of design, rather than an elaboration of detail, the architect has produced an extremely dignified range of buildings.

The massive memorial tower, placed at the northern end of the buildings, commands attention, its straight and simple lines harmonising well with the treatment of the main entrance and alcove projection on either side.

On a tablet of Portland stone in the north face of this tower will be the following inscription in leaded letters :—" In grateful memory of those from this parish who answered the call of duty, left all that was dear to them, fought valiantly, and gave their lives that we might live in freedom, in the Great War, 1914-1918. This Hall and Institute has been erected and presented for the use of their fellow parishioners by Reginald and Lydia Mardon, whose elder son was killed in the advance on Le Cateau, October 9th, 1918."

Of the internal features, the large hall, 60ft. × 26ft., has comfortable seating accommodation for 250 persons, and will be laid with a special maple dance floor ; in addition is the platform, running the full width of the hall and with an average depth of 10ft., and so arranged to lend itself conveniently for amateur dramatic or other entertainments. On the west side there is an attractive alcove, 35ft. × 9ft., forming a convenient adjunct to the hall for dancing and other social purposes. Adequate and convenient ladies' and gents' cloak rooms are provided on either side of a spacious entrance vestibule.

Accommodation for the cinema operator and apparatus will be provided on the first floor of the tower. The base of the tower opens directly into the hall, with a fine stone arch with carved capitals, providing additional seating accommodation and forming an extra exit.

An oak panelled council chamber, 22ft. by 14ft. is behind the south wall of the hall, with an approach from the hall, and a separate outside entrance.

At the south-west angle is the kitchen, 14ft. by 14ft. 6in. with pantry, etc., adjoining, and connected with the hall by a carving and service room, so arranged as to serve the club premises or hall as required. Beneath this is the heating chamber, in which will be installed two separate heating systems for hall and institute.

The club premises, which complete the plans, comprise a billiard social room, 30 ft. by 19 ft., exclusive of an ingle fireplace and raised dais bay, and a reading room 14 ft. by 14ft. 6in. The premises have a separate entrance hall and ladies' and gents' cloakroom accommodation. These premises, in their entirety, will be conveyed legally to Trustees. An offer has also been made by Mr. Mardon to the Committee of the adjoining field, Five Acres in extent, which is admirably suited for a Sports Ground and could be easily laid out for Tennis, Cricket and Football, at a nominal annual rental, with the option of ultimate purchase on very generous terms.

MEMORIAL HALL
SHIPLAKE · OXON



FREDERICK C. SAINSBURY ARCHT.
L.B. & A. MILDRETT E. M.C.I.
154, FRIAR STREET, READING.

THE
MEMORIAL HALL
& INSTITUTE
SHIPLAKE ON THAMES
OXFORDSHIRE

PLAN OF THE BUILDINGS

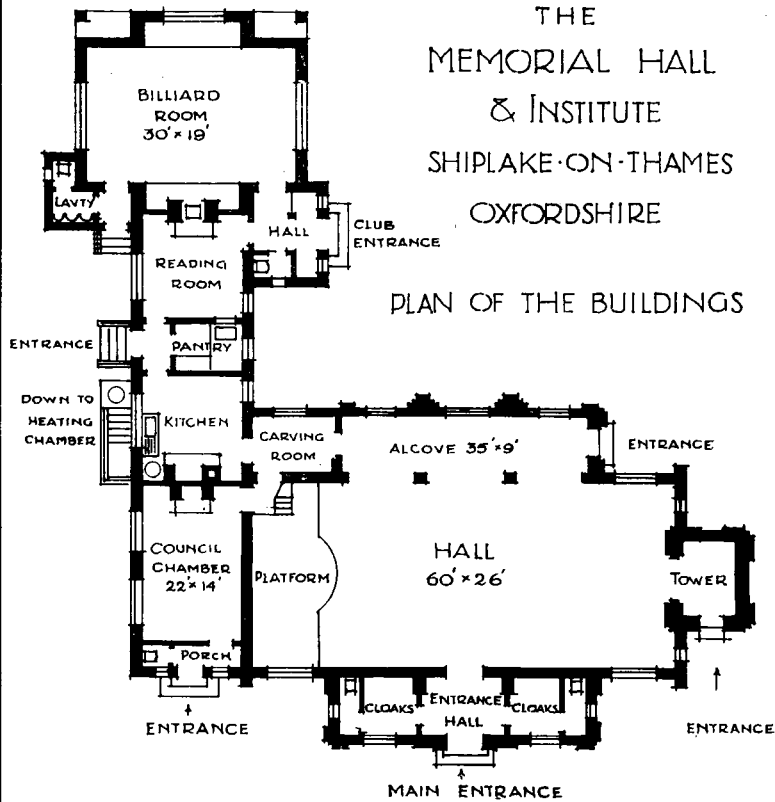

THE
MASONIC STONE LAYING CEREMONY

BY

W. BRO. MARK U. WEYLAND

(Deputy Provincial Grand Master of Oxfordshire),

ASSISTED BY THE

WORSHIPFUL MASTER AND OFFICERS

. . . OF THAMES LODGE, No. 1895. . .

HYMN I.

“O GOD OUR HELP.” (*St. Anne*).

O GOD, our help in ages past
Our hope for years to come,
Our shelter from the stormy blast,
And our eternal home :

Beneath the shadow of thy Throne,
Thy saints have dwelt secure ;
Sufficient is Thine Arm alone,
And our defence is sure.

Before the hills in order stood,
On earth received her frame,
From everlasting Thou art God,
To endless years the same.

A thousand ages in Thy sight
Are like an evening gone,
Short as the watch that ends the night
Before the rising sun.

Time, like an ever rolling stream,
Bears all its sons away ;
They fly forgotten, as a dream
Dies at the opening day.

O God, our help in ages past,
Our hope for years to come,
Be thou our guard while troubles last,
And our eternal home. Amen.

EXHORTATION BY THE VICAR OF SHIPLAKE.

BRETHREN, we are gathered together here to lay the Foundation Stone of a building which we humbly trust may in due time be set apart as a Memorial to our Brethren who gave their lives in the Great War.

And first, let us praise God's holy name for the mercy and goodness with which He has so far prospered our work ; and let us further devoutly pray that He will of his good Providence bless all who in any way contribute to its completion; that he will protect from danger those who may be engaged in the building; and that he will send his blessing upon our undertaking.

PSALM XXIII.

THE Lord is my shepherd; therefore can I lack nothing.
He shall feed me in a green pasture: and lead me forth beside the waters of comfort.

He shall convert my soul: and bring me forth in the paths of righteousness, for His Name's sake.

Yea, though I walk through the valley of the shadow of death, I will fear no evil: for thou art with me; thy rod and thy staff comfort me.

Thou shalt prepare a table before me against them that trouble me: thou hast annointed my head with oil, and my cup shall be full.

But thy loving-kindness and mercy shall follow me all the days of my life: and I will dwell in the house of the Lord for ever.

THE STONE LAYING.

Bro. Mardon requests the D.P.G.M. to address the gathering.

The D.P.G.M. Addresses the Gathering.

Chaplain offers prayer. S.M.I.B.

D.P.G.M. calls on Bro. Secretary to read inscription.

D.P.G.M. calls on Bro. Treasurer to deposit phial containing coins in cavity in stone.

I.P.M. hands trowel to D.P.G.M.

D.P.G.M. lays the Foundation Stone.

D.P.G.M. calls on Bro. J.W. who applies the Plumb Rule.

D.P.G.M. calls on Bro. S.W. who applies the Level.

D.P.G.M. calls on Bro. W.M. who applies the Square.

The D.P.G.M. proves the stone.

Chaplain delivers an oration.

D.P.G.M. invokes a blessing on the undertaking. S.M.I.B.

Chaplain recites portions from Volume of the Sacred Law.

Architect presents plans.

Three Past Masters severally present to the D.P.G.M. Corn, Wine and Oil.

Chaplain gives a Benediction. S.M.I.B.

THE CHAIRMAN OF THE COMMITTEE

WILL REQUEST

MRS. R. H. MARDON,

ASSISTED BY

OLIVE & LESLIE GRAY,

TO

UNVEIL THE MEMORIAL TABLET

THE VICAR WILL READ NAMES OF THE FALLEN

as follows:—

Charles Gorrell Barnes,	James Hinstead
D.S.O., M.C.	Alexander Irving
Tom Belcher	Reginald Mardon
Harold Bennett	Clarence Marnier
Eric Cheasley	Charles Montague
William Collins	Laurence Nicholson, D.S.O.
John Cox	Richard Painter.
Ernest Davies	William Pawley
Bryan Dewes	Philip Shehan
Robert Dobb	William Stenner
Robert Fairclough	Charles Smith
Albert Gale	George Tedder
Ernest Gibbs	Alfred Walters
Thomas Goff	Leslie Weston
Francis Gray	Jack Wickens
Harry Harris	George Wyatt
Cecil Harrison	George Young

DEDICATORY PRAYER BY BISHOP SHAW.

O GOD, the Father of all men, who through thy Son Jesus Christ didst give healing and salvation to the world; bless what we now do in laying this stone in thy Name, and be thou, we beseech Thee, the beginning, the increase, and the consummation of this our work which we do after the pattern of thy compassion and loving-kindness revealed to us in the same Jesus Christ thy Son, who with Thee and the Holy Ghost liveth and reigneth one God, world without end.—*Amen.*

HYMN II.

“ALL PEOPLE THAT ON EARTH DO DWELL.”

ALL people that on earth do dwell,
Sing to the Lord with cheerful voice;
Him serve with fear, His praise forth tell,
Come ye before Him and rejoice.

The Lord, ye know, is God indeed:
Without our aid, He did us make;
We are His flock, He doth us feed,
And for His sheep He doth us take.

O enter then His gates with praise,
Approach with joy His courts unto ;
Praise, laud, and bless His Name always,
For it is seemly so to do.

For why ? the Lord our God is good
His mercy is for ever sure ;
His truth at all times firmly stood,
And shall from age to age endure.

To Father, Son and Holy Ghost,
The God Whom Heav'n and earth adore,
From men and from the Angel-host
Be praise and glory evermore.

VOTE OF THANKS.

Proposed by SIR FREDERICK ELEY, Br. (*Chairman of Committee*).

Seconded by MR. C. F. HARDING (*Chairman of Parish Council*).

MR. MARDON'S REPLY.

PRAYER BY BISHOP SHAW.

ALMIGHTY and everlasting God, we give Thee humble thanks for the memory and good example of Thy servants who have laid down their lives in the service of our Country. We bless Thee for their courage and devotion : accept their sacrifice we pray Thee ; let it not be in vain that they have died in the cause of righteousness and honour. And as they have come out of great tribulation, grant them, O Lord that they may be pardoned and cleansed in the Blood of the Lamb, and received into Thy everlasting mercy, through Jesus Christ our Lord, to whom, with Thee and the Holy Ghost, be all honour and glory, world without end.—*Amen.*

Grant them O Lord eternal rest.

And let everlasting light shine upon them.

THE BLESSING.

THE LAST POST.

ONE MINUTE'S SILENCE.

THE REVELLE.

THE NATIONAL ANTHEM.

GOD save our Gracious King,
Long live our noble King,
God save the King.
Send him victorious,
Happy and Glorious,
Long to reign over us,
God save the King.

Masonic Procession reformed and returns to Schools.